

# QUICKSTART

Please contact us first with any questions or problems you have about the operation of your Crane Sinus Inhaler

☎ 1-888-599-0992

✉ [questions@crane-usa.com](mailto:questions@crane-usa.com)



## FILL RESERVOIR

Turn top housing counterclockwise to unlock and fill water reservoir. Line up the arrow with lock symbol to lock.

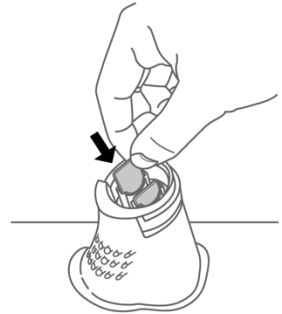

## ADD VAPOR PADS

Insert 1 or 2 vapor pads into the vapor pad trays at the bottom of the mask.

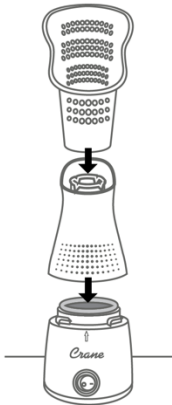

## SET UP

Place on a flat, stable surface and align all pieces.

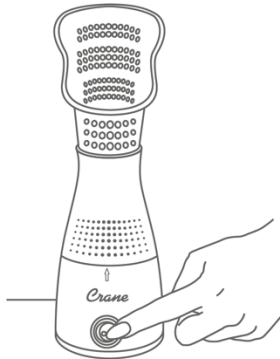

## SWITCH ON

Switch inhaler on. Visible steam will appear after 5 minutes.

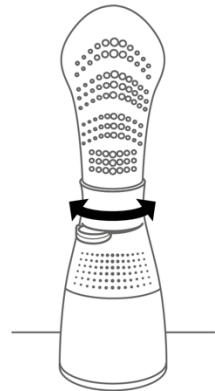

## ADJUST STEAM

Adjust steam output at the back of the inhaler to comfort level.

**DO NOT use additives or essential oils.**  
**CAUTION: Unit and water will become hot. Only operate inhaler with base and top housing in fully locked position.**

**FOR CLEANING & TROUBLESHOOTING  
REFER TO PAGE 7-8 IN THE MANUAL**

# **WARM STEAM Sinus Inhaler**

FOR MODEL EE-5959A



If you have any questions about the operation of your inhaler, please contact Crane Customer Care.

Toll Free: 888-599-0992

Email: [customer-service@crane-usa.com](mailto:customer-service@crane-usa.com)



**PLEASE READ AND SAVE ALL INSTRUCTIONS TO ENSURE  
THE SAFE AND EFFECTIVE USE OF THIS INHALER.**

# **SAVE YOUR DATED PROOF OF PURCHASE!**

[ You will need this in case of warranty]



## TABLE OF CONTENTS

Table of Contents & Sustainability	P. 1
Safety Instructions	P. 2-3
FCC Warning	P. 4
List of Main Parts & Technical Specifications	P. 5
Assembly & Use	P. 6-7
Maintenance & Storing Your Inhaler	P. 7-8
Customer Care & Trouble Shooting	P. 8
Warranty	P. 9

## Crane USA & SUSTAINABILITY



Crane USA is dedicated to your environment both inside and outside your home. We know if cleaned and maintained properly, our products last for years helping to reduce unnecessary use of resources and emissions making new products.

The Crane USA manual you are holding is from recycled materials with no added finishes or harmful dyes.

If the inhaler should no longer operate, please be sure to dispose of the unit in an environmentally friendly way by taking it to a public collection point.

**PLEASE DO NOT PLACE BROKEN INHALER WITH YOUR REGULAR HOUSEHOLD WASTE.**

## IMPORTANT SAFETY INSTRUCTIONS



**WARNING!** READ AND SAVE THESE INSTRUCTIONS. Failure to follow all of the instructions listed below may result in electric shock, fire and/or serious personal injury.

1. **KEEP OUT OF REACH OF CHILDREN.**
2. **DO NOT use this unit for any purpose other than described in this manual or packaging.**
3. Always turn off and unplug the inhaler after use.
4. Do not leave the inhaler unattended while it is plugged in.
5. Use only clean water to fill the water reservoir. **DO NOT use hot water.**
6. Be sure that the top is correctly attached to the water reservoir.
7. **ALWAYS plug and unplug unit with dry hands to avoid electric shock.**
8. Never operate the inhaler with a damaged cord or plug or if inhaler was dropped or immersed in water.
9. Always place the inhaler on a firm, flat, waterproof and heat resistant surface.
10. Ensure the inhaler is placed so the power cord not placed near a heat source and is safely out of the way to prevent the inhaler from being tipped over.
11. Do not drop, place or use the item while near or in water, bathtub, sink, etc.
12. NEVER reach for the inhaler that has fallen into the water. Unplug the inhaler immediately.
13. Do not add medication of any type directly into the water reservoir. Do not cover any openings on the unit or insert objects into any openings.
14. When cleaning the inhaler, DO NOT fully immerse the unit in water.
15. Do not tilt or tip the inhaler or attempt to empty or fill reservoir while it is in operation.
16. Do not use the inhaler while drowsy.
17. Always carry/lift the inhaler by the base. Do NOT lift the inhaler by the mask.
18. Unplug the inhaler before filling the water reservoir with water.
19. Do not attempt to repair this inhaler as this will void the warranty on the item.
20. Children should be supervised while using this product to ensure it is used as described and intended in the manual.
21. This product has been designed for personal use only. Do not use for industrial use.
22. Do not use outdoors or operate where aerosol (spray) products are being used or where oxygen is being administered.
23. Unplug this inhaler before filling. Fill (reservoir) with water only. Do not overfill (or specify filling instructions).

## SAVE THESE INSTRUCTIONS!

# GENERAL SAFETY INSTRUCTIONS



**WARNING!** Read and understand all instructions. Failure to follow all instructions listed below may result in electric shock, fire, or serious personal injury. The warnings, cautions, and instructions discussed in this instruction manual cannot cover all possible conditions and situations that may occur. It must be understood by the user that common sense and caution are a factor which cannot be built into this product, it must be supplied by the user.

## THIS INHALER IS NOT A TOY!

Children should be supervised while using this product.

### SAVE ALL INSTRUCTIONS!

**CAUTION:** A short Power Supply Cord is provided to reduce the risk of personal injury resulting from becoming entangled in or tripping over a longer cord. Extension cords are available from local hardware stores and may be used if care is exercised in their use. If an extension cord is required, special care and caution is necessary. Also, the extension cord must be (1) marked with an electrical rating of 110-240 V and at least 13 A., 1625 W., and (2) the cord must be arranged so that it will not drape over the countertop or tabletop where it can be pulled on by children or accidentally tripped over.

### ELECTRIC POWER

If the electric circuit is overloaded by other appliances, your inhaler and/or appliances may not operate properly. The inhaler should be operated on a separate electrical circuit from other operating appliances.

### POLARIZED PLUG

This inhaler has a polarized plug (one blade is wider than the other). As a safety feature to reduce the risk of electrical shock, this plug is intended to fit in a polarized outlet only one way. If the plug does not fit fully in the outlet, reverse the plug. If it still does not fit, contact a qualified electrician. Do not attempt to defeat this safety feature.



### SAFETY WARNING

Although your inhaler is easy to operate, for your safety, the below warnings must be followed:

1. Do not place the inhaler near a heat source.
2. Do NOT dispense medicine in the inhaler.
3. Never leave the inhaler unattended while connected to the electrical outlet.
4. Change water with each use.
5. Always use a clean steam mask with each use.
6. Do not unplug from the wall socket by pulling on the supply cord.
7. Do not move, tilt, shake or lift the inhaler while in operation as it contains hot water.
8. Base, water reservoir and water will become hot.
9. Do not operate the inhaler without water in the reservoir.
10. The inhaler must be unplugged:
  - A. After each use.
  - B. Before filling the water reservoir.
  - C. Before any cleaning or maintenance is performed.

## THIS PRODUCT IS INTENDED FOR PERSONAL USE ONLY

# **FCC WARNING**

This device complies with Part 15 of the FCC Rules. Operation is subject to the following two conditions: (1) this device may not cause harmful interference, and (2) this device must accept any interference received, including interferences that may cause undesired operation.

Warning: Changes or modifications to this unit not expressly approved by the party responsible for compliance could void the user's authority to operate the equipment. NOTE: This equipment has been tested and found to comply with the limits for a Class B ISM equipment, pursuant to Part 15 of the FCC Rules. These limits are designed to provide reasonable protection against harmful interference in a residential installation. This equipment generates, uses, and can radiate radio frequency energy and, if not installed and used in accordance with the instructions, may cause harmful interference to radio communications.

However, there is no guarantee that interference will not occur in a particular installation. If this equipment does cause harmful interference to radio or television reception, which can be determined by turning the equipment off and on, the user is encouraged to try to correct the interference by one or more of the following measures:

- Increase the separation between the equipment and receiver.
- Reorient or relocate the receiving antenna.
- Connect the equipment into an outlet on a circuit different from that to which the receiver is connected.

**Consult the dealer or an experienced radio/TV technician for help.**

**CRANE USA, INC.**

**1015 Hawthorn Dr., Itasca, IL 60143**

**Toll Free: 1-888-599-0992 (Monday-Friday 9:00am - 4:00pm CST)**

**Email: [customer-service@crane-usa.com](mailto:customer-service@crane-usa.com)**

**Website: [www.crane-usa.com](http://www.crane-usa.com)**

## LIST OF MAIN PARTS

**Fig. 1 (Inhaler)**

1. Silicone Mask
2. Vapor pad compartment (inside silicone mask)
3. Top housing
4. Vents
5. Steam Control
6. Vents
7. Base
8. Water Reservoir
9. Power Switch
10. Heating Element (inside unit)



## TECHNICAL SPECIFICATIONS

Rating Voltage	120V
Frequency	60Hz
Water Reservoir Capacity	40 ML
Power	130W



### CAUTION

- DO NOT attempt to operate the inhaler without water in the water reservoir.
- DO NOT plug or unplug the power cord with wet hands as electric shock could occur

# ASSEMBLY & USE

## SET UP THE INHALER

1. Fully unravel the cord.
2. Place the inhaler on a flat, stable surface with the cord out of the way to avoid the inhaler being tipped over.

## FILLING THE WATER RESERVOIR

**Remove:** Hold the inhaler and turn the top housing counterclockwise to unlock the top from the base. Lift the top off the base.

**Fill:** Fill water into the water reservoir in the base. Do Not fill past the max fill line

**Please Note:** Do NOT add essential oils, medicine, vapor pads or any additives into the water reservoir. This inhaler is designed to be used with Crane Vapor pads. **Do NOT dispense medicine in the inhaler.**

**Replace:** Place the top housing of the steam inhaler unit on the water reservoir base so the vent is in the front. Turn the top housing to the left so it locks into place.

**Note: the unit will not power on if the top housing is not locked into place**



Picture 1



Picture 2

## STEAM Mask (*Latex Free Steam Mask is Dishwasher Safe*)

Place steam mask on the body of the inhaler, do so by gently pressing the mask onto the top of the inhaler (see Picture #1)

## USING THE INHALER:

1. Connect the cord to the electrical outlet.
2. Press the power button to the ON position (represented by the dash icon).  
The green light will be on to indicate that the inhaler is powered on.

**NOTE: the unit will take 5-7 minutes to heat up**



**CAUTION: NEVER** move, lift, shake or tilt the inhaler while it is in use or while it contains hot water. **DO NOT** remove the Mask or Top Housing after turning ON the inhaler. Steam is produced by boiling water; tilting or shaking unit can cause water to spill and possible burns.

**NEVER** operate the inhaler without the top housing and base in fully locked position.



**CAUTION: DO NOT** block any vents or put hands over the vents as hot steam may cause possible burns. The base, the water reservoir, vent and water will become hot.

3. Place your face over the mask (Shown in picture 2 above), do NOT rest your face on the mask.
4. Breathe normally through your nose and mouth allowing the steam into our nasal and throat passages.
5. Press the power button to the OFF position.

**AUTOMATIC SHUTOFF:** When the inhaler runs out of water the light will turn RED and the unit will shut off automatically.

### **ADJUSTING THE STEAM SETTING**

1. For more steam: slide the steam control to the right
2. For less steam: slide the steam control to the left.



### **VAPOR PAD PRECAUTION**

**Not recommended for children under the age of 13**

#### **Vapor Pad Chamber**

Prior to running the inhaler, Insert 1 or 2 vapor pads into the compartment under the silicone mask. Change vapor pad(s) with each session.

**Note: vapor pads are entirely optional**

#### **VAPOR PADS**

**CAUTION:** Do not ingest vapor pads. Always keep out of reach of children and pets. If you are pregnant, breastfeeding, or have asthma, consult a doctor before use.

**DO NOT USE** if you suffer from epilepsy, pads may irritate skin and eyes. In case of irritation on skin or contact with eyes, rinse with plenty of water and seek medical advice. If accidentally ingested, seek medical advice immediately. In case of any discomfort stop usage and seek medical advice.

**DO NOT** place in microwave.

**DO NOT** place exposed pad on furniture, fabrics, bedding, and plastics.

**DO NOT** add any liquids to the pad.

**WARNING: VAPOR PAD MAY PRESENT A CHOKING HAZARD.**

## MAINTENANCE

- **ALWAYS UNPLUG FROM THE POWER SOURCE BEFORE CLEANING.**
  - **Do not immerse the inhaler in water.**
1. **To Clean the Outside of the Inhaler:**  
Wipe down the outside of the inhaler with a dry cloth. Do not immerse the body of the inhaler in water.
  2. **To clean the Latex Free Steam Mask:**  
**To Clean Mask in Dishwasher:** Place steam mask on TOP RACK only and run dishwasher on Normal setting.  
  
**To Clean Mask by Hand:** Remove the mask from the inhaler and wash with warm water and mild soap. Use a soft cloth or a soft brush to remove any residue. Allow the mask to air dry.
  3. **To Clean the Water Reservoir: Only clean water reservoir when the unit has cooled down completely.** Add 1 tablespoon of water and 1 tablespoon of white vinegar to water reservoir and let soak for 20 minutes and then empty and rinse the water reservoir.

### STORING YOUR INHALER

1. Turn off, unplug from outlet, and allow unit to cool down completely.
2. Discard vapor pad from the chamber.
3. Follow instructions for weekly maintenance above.
4. Let all parts dry completely.
5. Store in a cool, dry place.

## Crane USA CUSTOMER CARE

CALL US: 888-599-0992 (Mon-Fri 9:00am – 4:00pm CST)  
EMAIL US: [customer-service@crane-usa.com](mailto:customer-service@crane-usa.com)  
LIVE CHAT: available at [www.crane-usa.com](http://www.crane-usa.com)

## TROUBLESHOOTING

**DO NOT attempt to repair the inhaler yourself.**

**If the inhaler continues to not operate, please contact Crane USA Customer Care.**

Problem	Solution
<b>Inhaler Does Not Have Any Power:</b>	<ul style="list-style-type: none"><li>▪ Ensure unit is plugged into a wall outlet.</li><li>▪ Ensure a working outlet is being used.</li><li>▪ Ensure that the top housing is locked onto the base of the unit</li></ul>
<b>There is a Strange Odor:</b>	<ul style="list-style-type: none"><li>▪ Clean the water reservoir with a water &amp; white vinegar solution and rinse with clean water. (Page 8)</li></ul>
<b>Inhaler is Leaking</b>	<ul style="list-style-type: none"><li>▪ Ensure the top housing is attached securely onto the base of the inhaler.</li></ul>
<b>No Mist When the Unit is ON</b>	<ul style="list-style-type: none"><li>▪ Wait 5-7 minutes for warm mist to start being produced.</li></ul>

**NOTE: Spare Parts can also be purchased online at [www.crane-usa.com](http://www.crane-usa.com)**

# Crane USA WARRANTY

For more information regarding the warranty policy,  
please visit our website: [www.crane-usa.com/customer-service](http://www.crane-usa.com/customer-service)

## LIMITED WARRANTY

Thank you for purchasing a Crane USA product which has been tested to meet our stringent quality standards. This product is warranted to be free from manufacturing defects under normal use and conditions for 1 year.

**PLEASE CONTACT US BEFORE RETURNING THIS PRODUCT TO THE STORE.  
CALL CRANE CUSTOMER CARE FOR PROBLEMS AND QUESTIONS. WE CAN HELP.**

### WARRANTY REQUIRES A DATED PROOF OF PURCHASE.

This warranty is void if the defect is due to accidental damage, misuse, abuse, neglect, improper repair or alteration by unauthorized persons, or a failure to follow operating instructions provided with the product **including the use of essential oils**. This warranty does not apply to normal wear and tear or commercial use.

In no event shall liability exceed the purchase price paid by the purchaser of the product. Under no circumstances shall there be liability for any loss – direct, indirect or incidental – or consequential damage arising out of, or in connection with the use of this product.

**This warranty is valid only in the 48 contiguous states plus the District of Columbia** and excludes Puerto Rico and the Virgin Islands. This warranty is effective only if the product is purchased and operated in the United States of America.

Any instructions or warranty included in this manual may be subject to change without notice. For the most up-to-date instructions and warranty information, please contact us or visit our website.

**TO RECEIVE WARRANTY INSTRUCTIONS AND RETURN AUTHORIZATION,  
PLEASE CALL OR EMAIL CRANE CUSTOMER CARE.**

**CRANE USA, INC.**

1015 Hawthorn Dr., Itasca, IL 60143

Toll Free: 1-888-599-0992 (Monday - Friday 9:00am - 4:00pm CST)

Email: [customer-service@crane-usa.com](mailto:customer-service@crane-usa.com)

Website: [www.crane-usa.com](http://www.crane-usa.com)