

Crane

5-in-1 Air Purifier Bladeless Fan With UV Sterilization, Ionizer & Humidifier

FOR MODEL: EE-5625

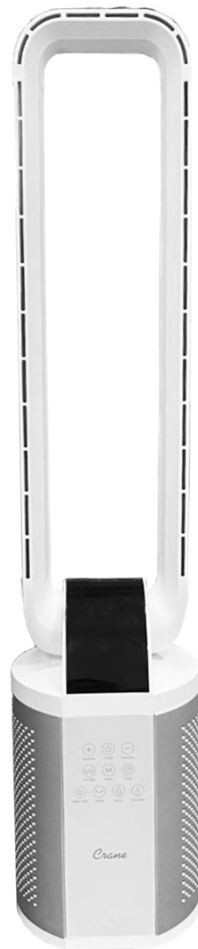

**PLEASE READ AND SAVE ALL INSTRUCTIONS TO
ENSURE THE SAFE AND EFFECTIVE USE OF THIS FAN.**

If you have any questions about the operation of your fan, please contact Crane Customer Care.

SAVE YOUR DATED PROOF OF PURCHASE!

[You will need this in case of warranty]



staple
tape
or paperclip
your
receipt
HERE

TABLE OF CONTENTS

Table of Contents & Sustainability	P. 1
Safety Instructions	P. 2-3
List of Main Parts	P. 4
Technical Specifications, Assembly & Use	P. 5-6
Maintenance & Storing Your Fan	P. 7-10
Warranty	P. 11

CRANE & SUSTAINABILITY

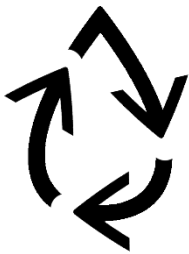

Crane is dedicated to your environment both inside and outside your home. We know if cleaned and maintained properly, our products last for years helping to reduce unnecessary use of resources and emissions making new products.

The Crane manual you are holding is from recycled materials with no added finishes or harmful dyes. If the Fan should no longer operate, please be sure to dispose of the unit in an environmentally friendly way by taking it to a public collection point.

PLEASE DO NOT PLACE BROKEN FANS WITH YOUR REGULAR HOUSEHOLD WASTE.

IMPORTANT SAFETY INFORMATION



WARNING! READ AND SAVE THESE INSTRUCTIONS. Failure to follow all of the instructions listed below may result in electric shock, fire and/or serious personal injury.

1. It is advisable to carry filled Water Tank with two hands.
2. **DO NOT operate outdoors. This fan is intended for indoor use only.**
3. Always have water in the Water Tank when operating the unit.
4. Use only clean, cool tap water to fill the Water Tank (filtered or distilled water is recommended to avoid white dust if tap water is too hard. **DO NOT use hot water.**
5. Use only a 110-240VAC outlet.
* **ALWAYS plug and unplug unit with dry hands to avoid electric shock.**
6. Never operate the unit with a damaged cord or plug.
7. Always place the unit on a smooth, flat, lint-free, and level surface and position unit away from direct sunlight. Keep the cord away from heated surfaces and areas where it could be walked on or tripped over. Unplug the unit when not in use and whenever you clean or move the unit.
8. Do not add medication of any type into the Water Basin or Water Tank. Do not cover any openings on the unit or insert objects into any openings.
9. The unit should not be left unattended in a closed room.
10. When cleaning the inside of the fan, keep water away from the Fan Vent. **Turn off and unplug the fan to wipe the exterior** (except the electrical controls) with a damp cloth. Fan requires regular cleaning. Please refer to the CLEANING INSTRUCTIONS in this manual.
11. Do not tilt or tip the Fan or attempt to empty or fill it while it is in operation.
12. Do not use a detergent to clean any parts of the unit that contain water. Detergent film dissolved in the water supply can interfere with the output of the unit. Instead, always use white vinegar mixed with water to clean the fan.

SAVE THESE INSTRUCTIONS!

GENERAL SAFETY INFORMATION



WARNING! Read and understand all instructions. Failure to follow all instructions listed below may result in electric shock, fire or serious personal injury. The warnings, cautions, and instructions discussed in this instruction manual cannot cover all possible conditions and situations that may occur. It must be understood by the user that common sense and caution are a factor which cannot be built into this product, but must be supplied by the user.

THIS FAN IS NOT A TOY!

Do not let your child play with this fan. Serious injury and electrocution might be possible. This fan has to be operated by an adult only. Children should be supervised to ensure that they do not play with the fan.

SAVE ALL INSTRUCTIONS!

CAUTION: A short Power Supply Cord is provided to reduce the risk of personal injury resulting from becoming entangled in or tripping over a longer cord. Extension cords are available from local hardware stores and may be used if care is exercised in their use. If an extension cord is required, special care and caution is necessary. Also the extension cord must be (1) marked with an electrical rating of 125 V and at least 13 A., 1625 W., and (2) the cord must be arranged so that it will not drape over the countertop or tabletop where it can be pulled on by children or accidentally tripped over.

ELECTRIC POWER

If the electric circuit is overloaded by other appliances, your fan and/or appliances may not operate properly. The fan should be operated on a separate electrical circuit from other operating appliances.



SAFETYWARNING

Although your fan is easy to operate, for your safety, the below warnings must be followed:

1. Do not place the fan near a heat source.
2. Never leave the fan unattended while connected to the electrical outlet.
3. To avoid any accidents, never cover the Mist Lid when the fan is in operation.
4. Use the fan on a smooth, flat, lint-free, non-metallic, waterproof, and level surface away from water.
5. Do not unplug from the wall socket by pulling on the supply cord.
6. The fan must be unplugged:
 - A. Before either filling or emptying the Water Basin and/or Water Tank.
 - B. Before any cleaning or maintenance is performed.
 - C. After each use.
 - D. If it appears to be faulty.

THIS PRODUCT IS INTENDED FOR HOUSEHOLD USE ONLY.

LIST OF MAIN PARTS

Fig. 1 (Front)

- 1. Air outlet
- 2. Display
- 3. Touch controls
- 4. Remote control receiver

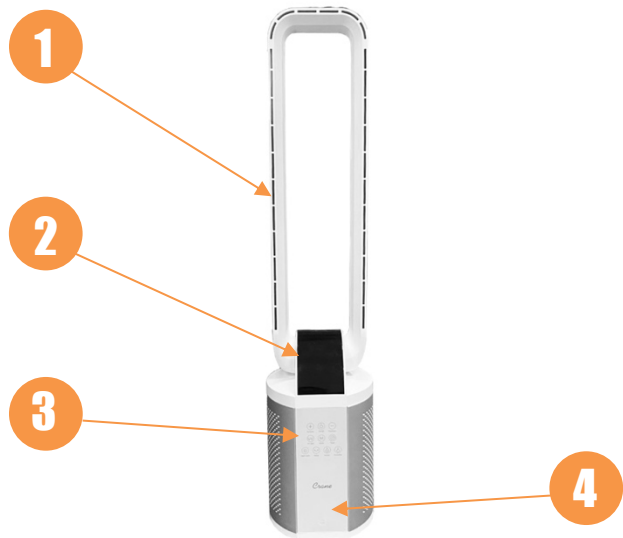

Fig. 2 (Side)

- 5. Water tank
- 6. Air inlet
- 7. Filter cover lock
- 8. Light

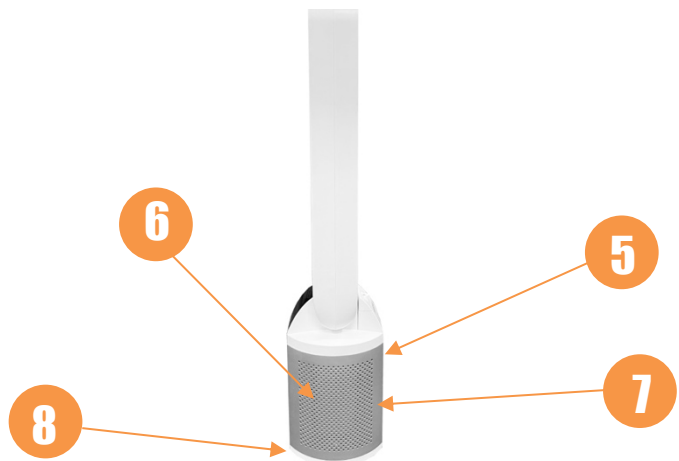

Fig. 3 (parts removed)

- 9. Water tank
- 10. Water tank cap
- 11. Filter
- 12. Remote control



TECHNICAL SPECIFICATIONS

Rating Voltage	100-240V
Wattage	40W
Frequency	50/60Hz
Water Tank Capacity	.2 gallons
Run Time Per Tank	4-6 hours
Humidifying Capacity	32ml/h
Noise Level	52dB - 55dB

BEFORE EACH USE:

CHECK FAN PLACEMENT:

- Place the unit on a flat solid surface
- Avoid blocking the air intake.
- Do not place any objects within 30 CM of the base of the unit as they may impact air flow.



CAUTION

- DO NOT plug or unplug the Power Cord with wet hands as electric shock could occur.

ASSEMBLY & USAGE

REMOTE CONTROL:

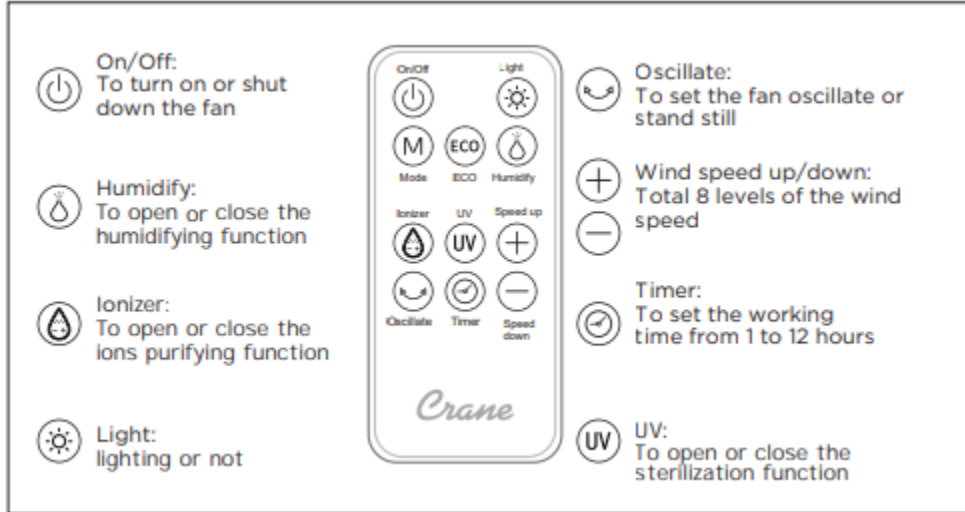

	Press the "On/Off" button to power the fan on. Press the "On/Off" button again to power the unit off.
	Press the "Oscillate" button to make the unit start oscillating from left to right. Press the button again to shut off the oscillate function.
	Press the "Timer" button to set the timer function for 1 to 8 hours.
	Press the "+/-" button to increase or decrease the fan intensity
	Press the "humidity" button to turn on the humidifier function. Press the button again to power off the humidifier function.
	Press the "UV" button to power on the UV light. Press the button again to power off the UV function.
	Press the "Ionizer" button to power on the Ionizer function. Press the power button again to power off the Ionizer function.
	Press the "mode" to cycle through the unit's preset modes

MAINTENENCE

REPLACING THE BATTERY:

1. Remove the battery compartment by pinching the tab and pulling the compartment out as below picture.
2. Remove the old battery.
3. Replace with a new CR2025 battery. Make sure that the polarities match. Replace the battery compartment.

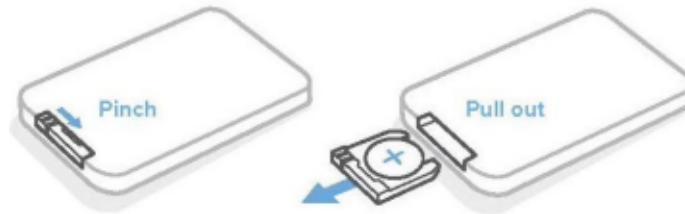

Note:

1. This fan may respond to the remote control of other appliances.
2. Other appliance may respond to the remote control of this fan. These phenomena are due to the overlapping signals of the remote control. To avoid false control input, just keep the remote control away from other appliances when adjusting the fan.

ADJUST THE WIND DIRECTION

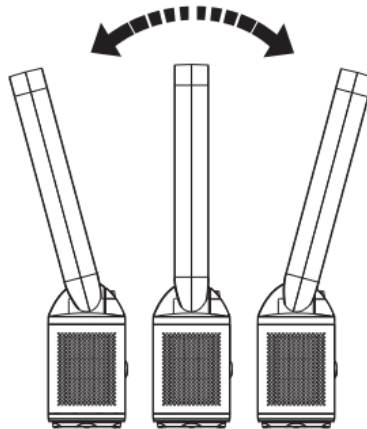

The adjustment can only be carried on when the fan is not working. Please stabilize the fan body and gently swing the air flue. The adjustable angle range is 15° up and down.

POWER ON THE UNIT

Press the power button on the touch control panel or on the remote control. The unit will beep and the fan will start on fan speed 5.

Press the power button again to power the unit off.

ADJUST FAN SPEED

Press the "+" or "-" button to raise or lower the fan speed from power levels 1 through 8. **Note:** pressing the "+" button on fan speed 8 will set the unit back to fan speed 1.

HUMIDIFIER

Press the "humidity" button to power on the fan's humidifier function. The unit will start to humidify the air, using the water in the water tank. The humidifier icon will light up on the front of the unit while in operation.

FILLING THE TANK:

The water tank is located next to digital display on the front of the unit. Remove the tank by pulling up on it. The top portion of the tank can be unlocked by giving it a quarter turn to the left. You can then fill the tank to the top with water, before locking the top back onto the tank and returning it to the base of the unit.

IONIZER:

Press the "ionizer" button to power on the ionizer function. The ionizer will work to purify the air. The ionizer icon will light up on the front of the unit while in operation.

LIGHT:

Press the "light" button to turn on the light feature that illuminates around the base of the unit. The light icon will be displayed on the front of the unit during operation.

With the light feature powered on, press and hold the light button to change the brightness from the brightest light setting to the dimmest light setting. Press and hold the light feature a second time to change the brightness from the dimmest light setting to the brightest light setting. Press the light button once to power off the light feature.

TIMER:

Press the "timer" button to start the timer feature. The timer icon will be illuminated on the front of the unit along with the number 1. Press the "+" or "-" button to adjust the timer to the desired amount of hours. The timer can be set between 1 and 12 hours.

Press and hold the timer button for 3 seconds to power off the timer feature.

MODE:

Press the "Mode" button to cycle through the different preset modes.

Night Mode: Night Mode Sets the unit on its quietest and dimmest settings, while still working strong enough to circulate air.

Natural Wind Mode: Natural Wind Mode starts on fan speed 1 and then gradually increases to fan speed 4. Once it reaches fan speed 4, it then decreases to fan speed 1. One full cycle lasts 42 seconds.

Eco Mode: Eco Mode senses the current temperature in the room, and adjusts the fan speed based on that temperature.

temp. : 20°C—22°C—24°C—26°C—28°C—30°C—32°C—>32°C

level: 01— 02 — 03—04 — 05 — 06 —07 —08

- When the temperature is below 18 degrees Celsius, the unit will run on the "LO" fan speed.
- When the temperature is above 35 degrees Celsius, the unit will run on the "HI" fan speed.

MODE (cont.):

Sterilization Mode: Sterilization mode utilizes the UV light at its' maximum capacity to help purify the air

Formaldehyde Mode: Formaldehyde mode helps freshen the air by eradicating debris in the air.

Odor Eradication Mode: Odor eradication mode helps remove bad odors in the air.

OSCILLATION:

Press the "Oscillate" button to power on the oscillation feature. The unit will slowly oscillate from side to side.

REPLACING THE FILTER

The EE-5625 is equipped with an air filter. Before operating the fan please ensure that the filter is installed. To replace the filter:

1. Loosen the lock then remove the air inlet cover.
2. Remove the purifier filter to clean or replace it.
3. Reinstall the clean/new filter.
4. Reinstall the air inlet cover and lock into place.

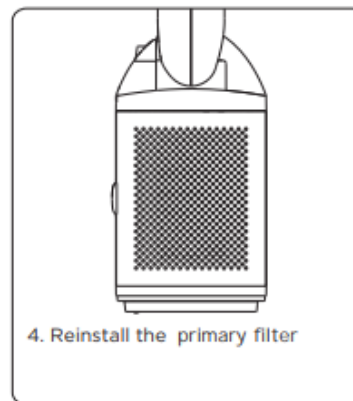
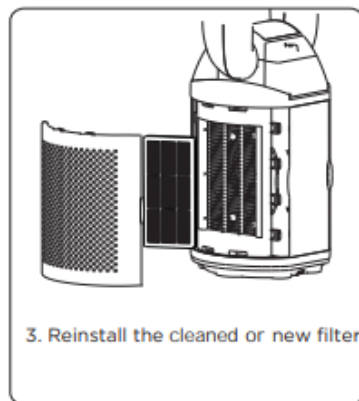
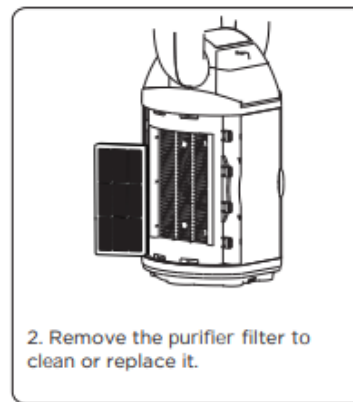
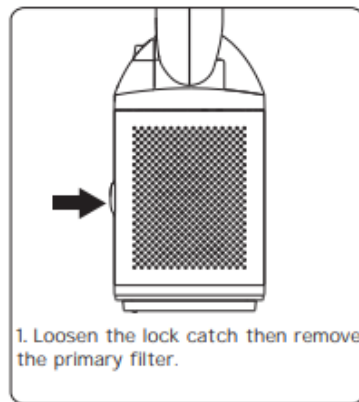

Cleaning and disinfecting on a regular basis is important for maintaining the performance of your fan.

IMPORTANT: Water left in the tank or base when not in use may result in buildup of mineral deposits and bacteria which may inhibit the output efficiency as well as void the warranty. If water remains in the Water Tank for more than a day or two, bacterial growth is possible.

DAILY MAINTENANCE

1. Turn off, unplug from outlet, and empty water from tank & base daily.
2. Allow tank & base to air dry.
3. Leave cap off the tank until ready for next use.

WEEKLY MAINTENANCE

1. Unplug the unit.
2. Wipe down the unit with damp cloth (avoiding the digital display)
3. Dry off unit with a dry cloth.
4. Vacuum out air inlet with a vacuum hose.
5. Clean out water tank by filling half way with water and two tablespoons of distilled white vinegar. Shake vigorously and let sit and soak for 30 minutes. Empty the tank of the cleaning solution, rinse with clean cool water, then allow the water tank to fully air dry.

END-OF-SEASON MAINTENANCE & STORING YOUR FAN

1. Store in a box or plastic bag.
2. Keep away from appliances with a heating or cooling function.
3. Do not place in direct sunlight or places with high humidity.
4. Do not store in direct sunlight.
5. Keep out of reach of children.

CRANE WARRANTY

For more information regarding the warranty policy,
please contact us.

LIMITED WARRANTY

Thank you for purchasing a Crane product which has been tested to meet our stringent quality standards. This product is warranted to be free from manufacturing defects under normal use and conditions for 1 year.

**PLEASE CONTACT US BEFORE RETURNING THIS PRODUCT TO THE STORE.
CALL CRANE CUSTOMER CARE FOR PROBLEMS AND QUESTIONS. WE CAN HELP.**

WARRANTY REQUIRES A DATED PROOF OF PURCHASE.

This warranty is void if the defect is due to accidental damage, misuse, abuse, neglect, improper repair or alteration by unauthorized persons, or a failure to follow operating instructions provided with the product. This warranty does not apply to normal wear and tear or commercial use.

In no event shall liability exceed the purchase price paid by the purchaser of the product. Under no circumstances shall there be liability for any loss – direct, indirect or incidental – or consequential damage arising out of, or in connection with the use of this product.

This warranty is valid only in Nepal and the Philippines. This warranty is effective only if the product is purchased and operated in Nepal or the Philippines.

Any instructions or warranty included in this manual may be subject to change without notice. For the most up-to-date instructions and warranty information, please contact us or visit our website.

**TO RECEIVE WARRANTY INSTRUCTIONS AND RETURN AUTHORIZATION,
PLEASE CALL OR EMAIL CRANE CUSTOMER CARE.**

Crane